

HYBRID-WALL®

HYBRID-WALL® by Sota was developed as an alternative to traditional window wall systems. Window walls are typically limited in their architectural aesthetic and performance capabilities. HYBRID-WALL® has greater flexibility in design to allow for larger expanses of glazing, flush external appearance (capless framing), and a variety of features and infill materials.

In addition to design versatility, HYBRID-WALL® provides the exceptional weather and seismic performance of a pressure

equalized, unitized rain screen curtain wall. The distinguishing feature of Sota's HYBRID-WALL® is its ability to install between floor slabs like a standard window wall, while maintaining the superior performance of a pre-glazed, unitized curtain wall.

HYBRID-WALL® is notched around the floor slabs, and allows the use of glass spandrels at the slab edge in lieu of metal panel covers. Because it is a true unitized curtain wall system, it employs a horizontal

expansion assembly incorporating silicone gaskets. This renders the typical sealant joints between floor slabs and a window wall system obsolete.

HYBRID-WALL® has fully integrated fixed and sliding anchors incorporated into the slab edge design. This insures ease of installation while allowing for construction slab tolerances and vertical live load movement between floor levels.

Superior product. Superior performance.

hw

3D IMAGE OF SLAB EDGE ANCHOR DETAIL HYBRID-WALL® UNDERSIDE OF SLAB

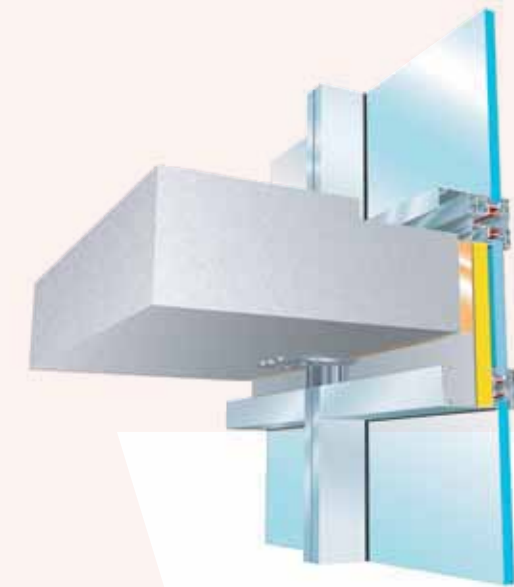

3D IMAGE OF SLAB EDGE ANCHOR DETAIL HYBRID-WALL® TOP OF SLAB

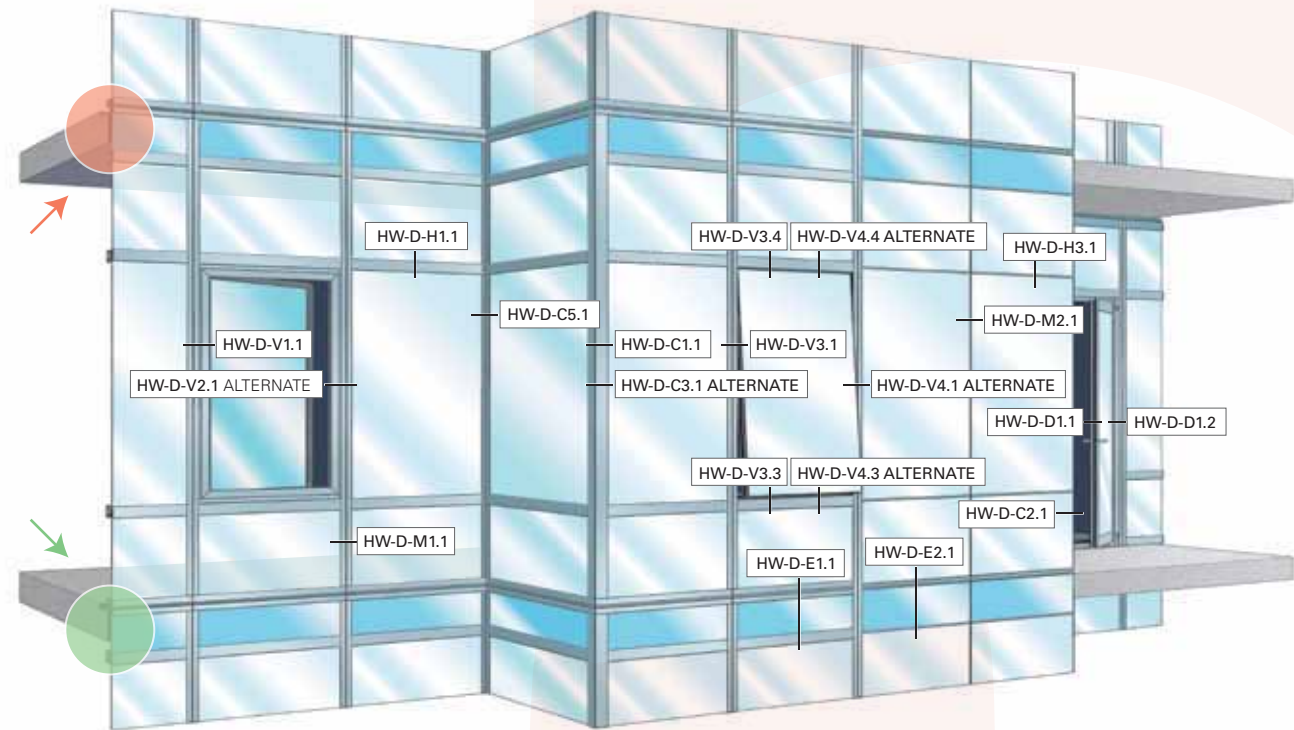
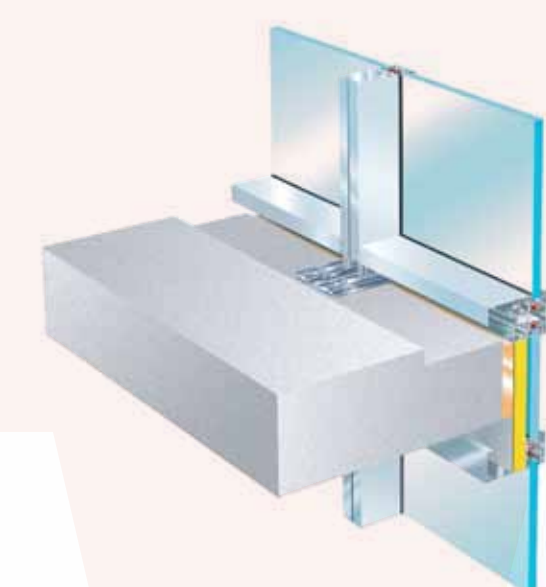

VISION AREA SPANDREL AREA

HW-D-E1.1 EXP. JOINT / ANCHOR DETAIL CAPPED MULLIONS

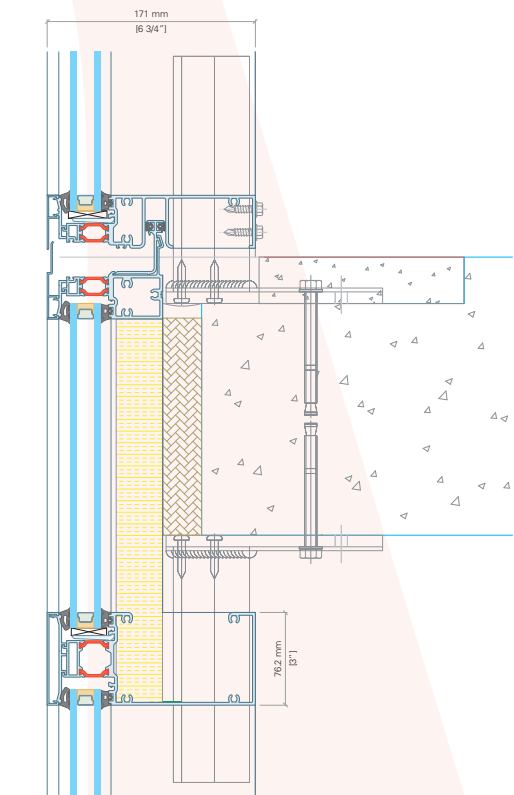

HW-D-E2.1 EXP. JOINT / ANCHOR DETAIL 4 SIDED SILICONE MULLIONS

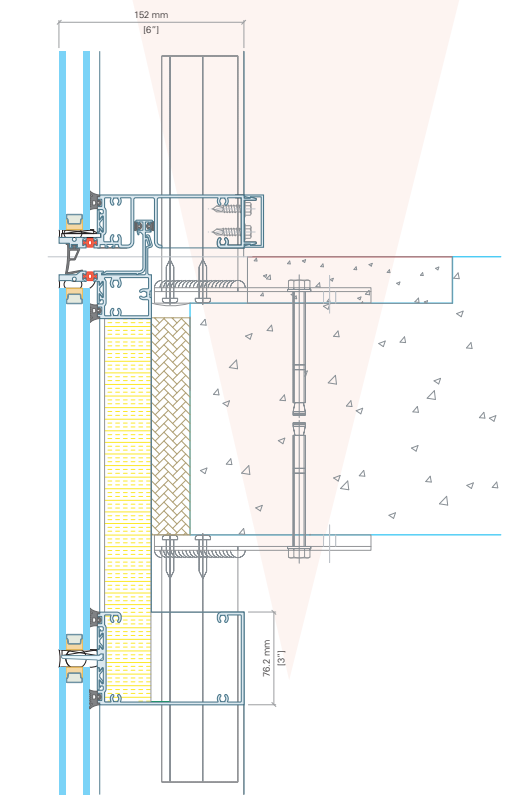

HW-D-D1.1 JAMB DETAIL AT BALCONY DOOR

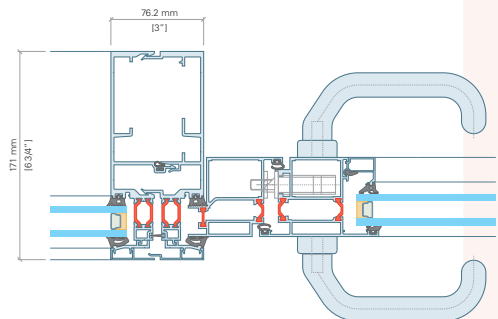

HW-D-D1.2 JAMB DETAIL AT BALCONY DOOR

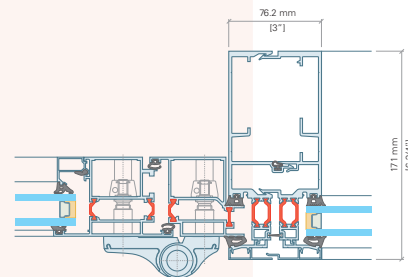

Sotawall Inc., 443 Railside Drive, Brampton Ontario, L7A 1E1 CANADA

Toll-Free 1 866 846 SOTA, Fax 905 846 3530, mailbox@sotawall.com www.sotawall.com

Hybrid-Wall® is a registered trademark of SOTAWALL INC. in the U.S. and Canada.

U.S. Patent **US 7,644,549 B2**
Canadian Patent **2 510 989**

310 East 53rd St.
3D Rendering from SLCE Architects

The Lancaster
Loewenberg Associates Inc.

The Regatta
3D Rendering from DeStefano + Partners

350 West 42nd St.
3D Rendering from Cetra/Ruddy, Inc.

SOTAWALL



HW-D-H1.1
4 SIDED CAPPED HORIZONTAL AT VISION

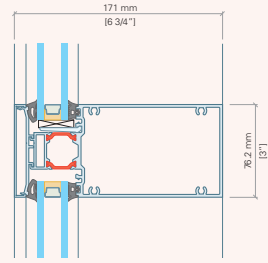

HW-D-H3.1
4 SIDED SILICONE HORIZONTAL AT VISION

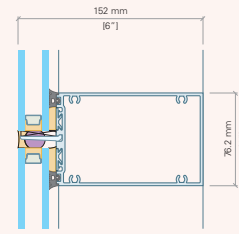

HW-D-M1.1
4 SIDED CAPPED MULLION AT VISION

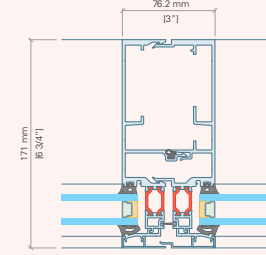

HW-D-M2.1
4 SIDED SILICONE MULLION AT VISION

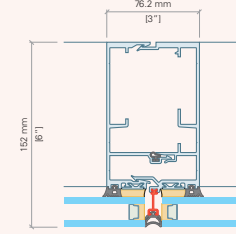

HW-D-C2.1
SILICONE CORNER MULLION

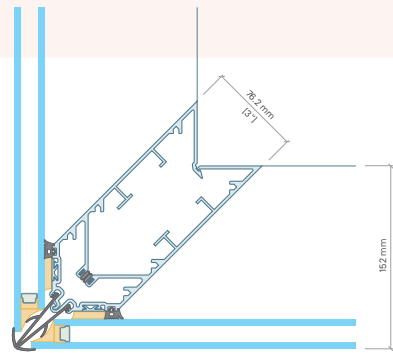

HW-D-C5.1
CAPPED INSIDE CORNER MULLION

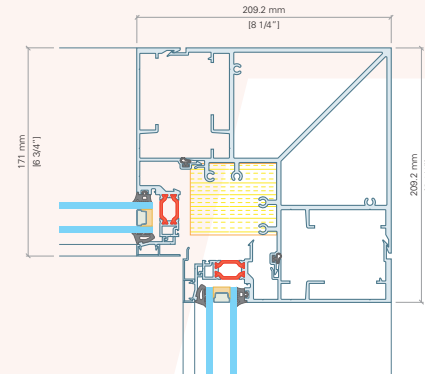

HW-D-C1.1
CAPPED CORNER MULLION

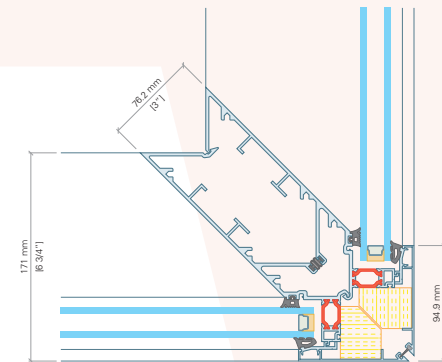

HW-D-C3.1
CAPPED CORNER

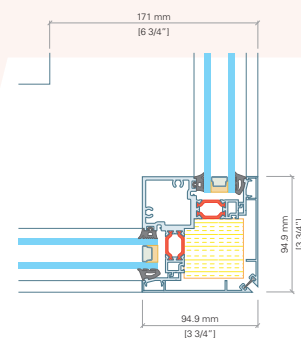

HW-D-V1.1
VENT JAMB DETAIL (OPENING TO INSIDE)

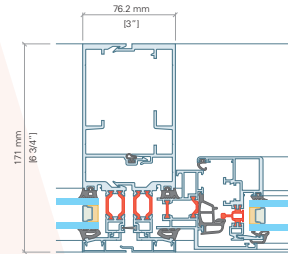

HW-D-V3.1
VENT JAMB DETAIL

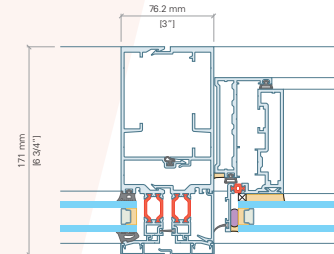

HW-D-V3.3
VENT SILL DETAIL

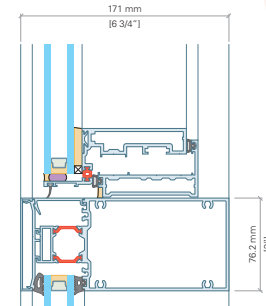

HW-D-V3.4
VENT HEAD DETAIL (WITH CONT. TOP HINGE)

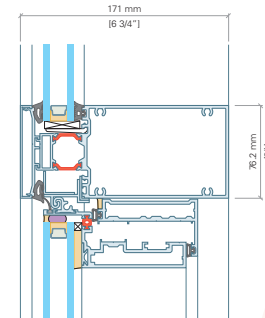

HW-D-V2.1
VENT JAMB DETAIL (OPENING TO INSIDE)

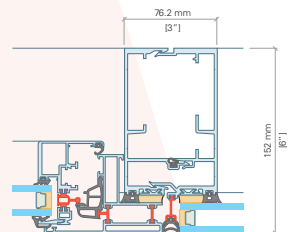

HW-D-V4.1
VENT JAMB DETAIL

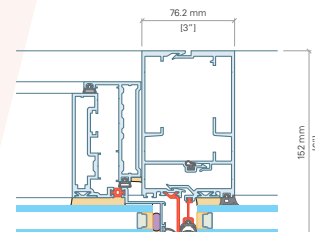

HW-D-V4.3
VENT SILL DETAIL

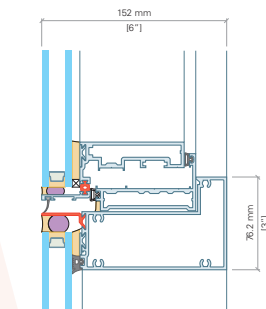

HW-D-V4.4
VENT HEAD DETAIL (WITH CONT. TOP HINGE)

